

\$787,000

mikegreerhomes

Cromwell

Lot 255 Wooing Tree Estate Central Otago District



Artist's Impression Only

for sale

dwelling size | section size
121 m² | 252 m²

homes
for
sale

Perfect for families and entertaining, this home is designed to maximise space and sun. The open plan living, dining and kitchen area is the centre of the home, and offers a great outlook onto the easy care section. With 3 bedrooms, a family bathroom and extra toilet, the house combines great functionality with a stylish feel. The home has an internal access garage.

Fringed by vines, this new development will retain and celebrate its unique location, with pride of place reserved for the iconic Wooing Tree. The vineyard and its cellar door will remain a key focus of the development, the beating heart of the wonderful new neighbourhood. The development will also be supported by carefully selected hospitality and retail businesses that will promote the local wine and tourism industry.

more features.

- ✦ Designer Kitchen
- ✦ Driveway and Patios Included
- ✦ Open Plan Living
- ✦ Pantry
- ✦ Smeg Appliances
- ✦ Designer Tapware

Home and Land Package

A Home and Land Package is a section and home combination with finance options available.

Special T&C's apply to this package.

bringing you **more**

03 443 2065

mikegreerhomes.co.nz

Wooring Tree Estate Lot 255 Wooring Tree Estate Central Otago District

WN0827

dwelling size | section size

121 m² | 252 m²

3 2 1 1 1



After Sales Care

At Mike Greer Homes we are committed to making the build journey as stress-free as possible. Our After Sales Care programme addresses any maintenance issues and ensures that any remedial work is undertaken once it is logged and approved.

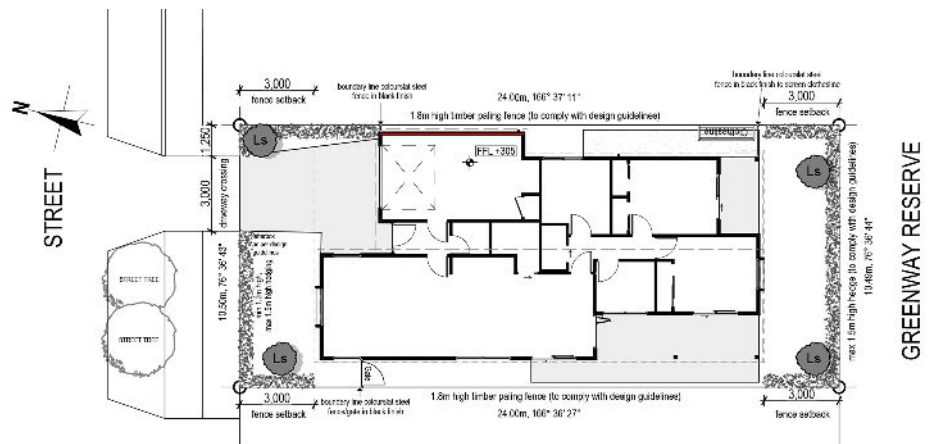

Disclaimer. While every reasonable effort has been made by Mike Greer Homes to ensure the information correctly illustrates the dwelling and section, this material may only be used by the Purchaser for illustrative and guidance purposes. Mike Greer Homes accepts no responsibility for any differences, errors or omissions which may become apparent during or on completion of the dwelling.