



+ 2953 - WOONG TREE ESTATE - STAGE 3A WORKING DRAWINGS

22 Aug 2023

2953-WD401 - STAGE 3A SITE PLAN
2953-WD402 - STAGE 3A MATERIALS PLAN
2953-WD403 - STAGE 3A PLANTING PLAN
2953-WD404 - STAGE 3A INTERSECTION DETAIL
2953-WD405 - STAGE 3A SCHEDULES

2953-WD228 - PLANTING SCHEMATIC
2953-WD241 - TYPICAL PLANTING BED PLAN
2953-WD242 - TYPICAL ROAD CORRIDOR
2953-WD243 - TYPICAL LOT ENTRIES
2953-WD244 - TYPICAL PARALLEL PARK
2953-WD245 - TYPICAL SECTIONS
2953-WD246 - POST AND RAIL DETAILS



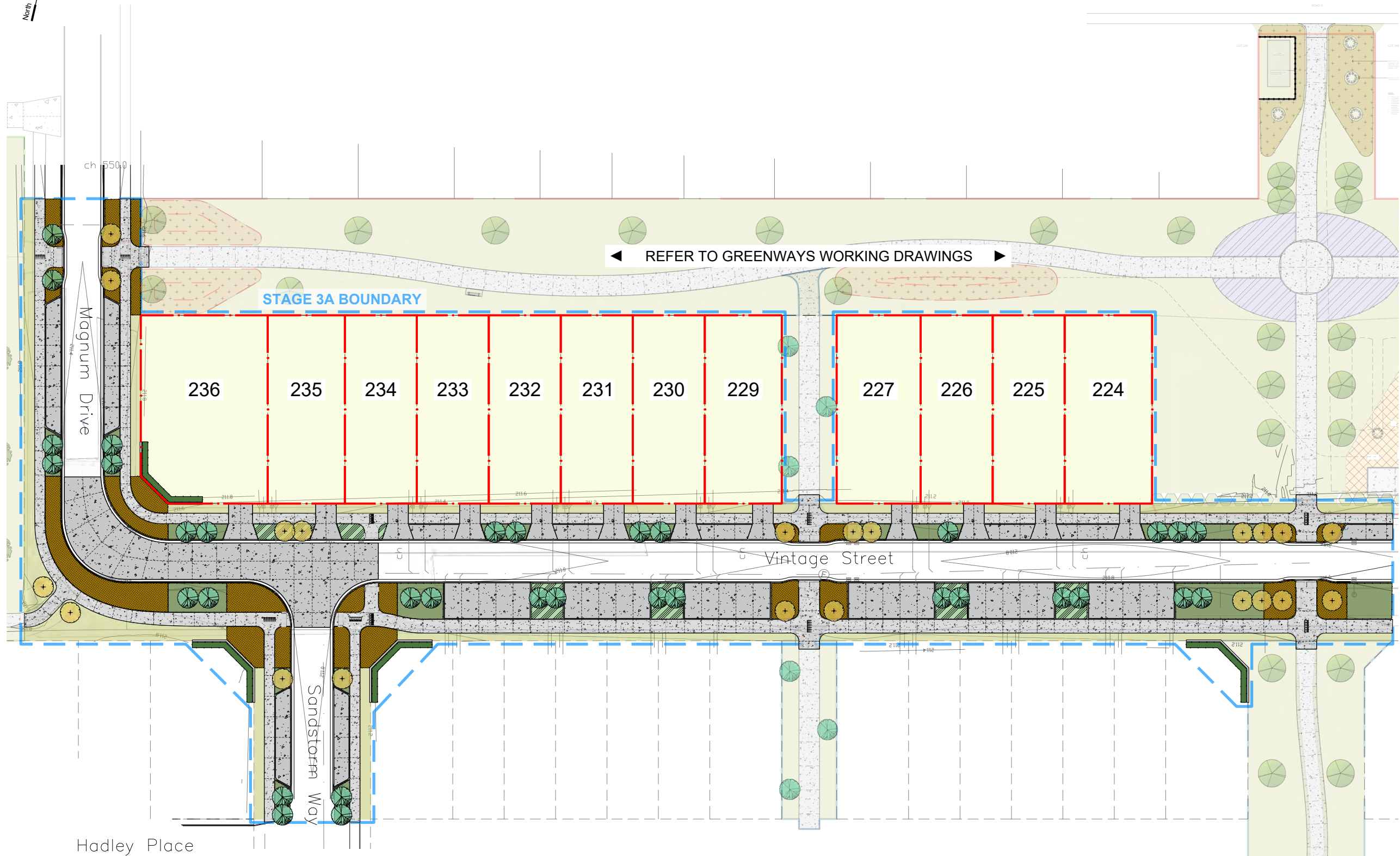
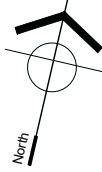

VEROS PROPERTY SERVICES

Woong Tree Estate

2953-WD401
Stage 3A Site Plan

CONSULTANTS
Project Managers
Architect
Engineer
Surveyor
Paterson Pitts
Others

REVISIONS		
Rev.	Date	Description
0	06 Jun 2023	First Issue

Drawing Title:	Stage 3A Site Plan
Scale:	As shown
Date:	Oct 2019
Sheet Number:	WD401
Job Number:	2953
Designed:	GH
Drawn:	GH
Checked:	---

DO NOT SCALE DRAWING
CONTRACTOR TO VERIFY ALL DIMENSIONS PRIOR TO COMMENCING ANY WORK. CAD FILE AVAILABLE FOR SETOUT ON REQUEST. © BAXTER DESIGN

1 SITE PLAN
Scale: 1:300 at A1 / 1:600 at A3

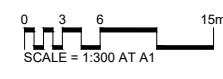

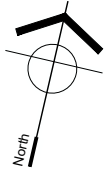

VEROS PROPERTY SERVICES

Woong Tree Estate

2953-WD402
Stage 3A Materials Plan

CONSULTANTS	
Project Managers	
Architect	
Engineer	
Surveyor	
Paterson Pitts	
Others	

REVISIONS		
Rev.	Date	Description
0	06 Jun 2023	First Issue

Drawing Title: Stage 3A Materials Plan

Scale: As shown

Date: Oct 2019

Sheet Number: WD402

Job Number: 2953

Designed: GH

Drawn: GH

Checked: ---

DO NOT SCALE DRAWING
CONTRACTOR TO VERIFY ALL DIMENSIONS PRIOR TO COMMENCING ANY WORK. CAD FILE AVAILABLE FOR SETOUT ON REQUEST. © BAXTER DESIGN

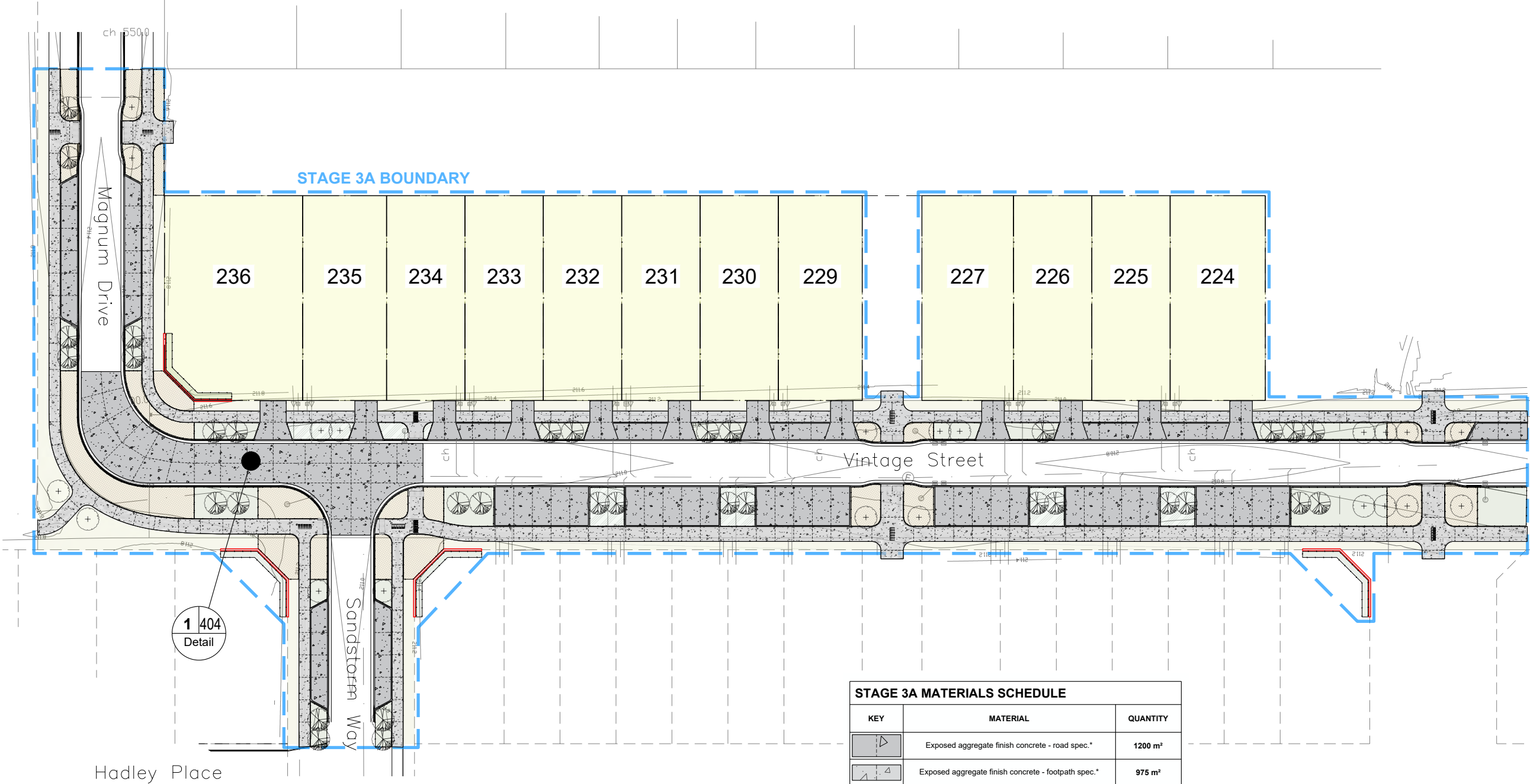

STAGE 3A MATERIALS SCHEDULE		
KEY	MATERIAL	QUANTITY
	Exposed aggregate finish concrete - road spec.*	1200 m ²
	Exposed aggregate finish concrete - footpath spec.*	975 m ²
	Post and rail fencing. Refer : WD246	64 Lm 4No.
	Tactile studs at footpath crossings. Reference: GMSSS10 from Freedom Strategies	6200
	Tactile directional indicators. Reference: GMSSD10 from Freedom Strategies	382
	2x 75mmØ tanalised H4 stakes to each tree, refer WD245 All pairs of posts to be consistently aligned	106

- * All exposed aggregate finish concrete to have sawcuts as shown at fixed spacings
- * Footpaths to have sawcuts at 3m [maximum] even spacings, coordinated at parking bays
- * Sawcuts shown dashed for clarity
- * Contractor to verify all quantities before construction
- * CAD file available for setout on request

1 SITE PLAN
Scale: 1:300 at A1 / 1:600 at A3

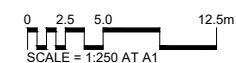



VEROS PROPERTY SERVICES

Wooring Tree Estate

2953-WD403

Stage 3A Planting Plan

CONSULTANTS
Project Managers

Architect

Engineer

Surveyor

Paterson Pitts

Others

REVISIONS

Rev.	Date	Description
0	06 Jun 2023	First Issue
A	22 Aug 2023	Trees revised to suit street lighting

Drawing Title: Stage 3A Planting Plan

Scale: As shown

Date: Oct 2019

Sheet Number: WD403

Job Number: 2953

Designed: GH

Drawn: GH

Checked: ---

DO NOT SCALE DRAWING
CONTRACTOR TO VERIFY ALL DIMENSIONS PRIOR TO COMMENCING ANY WORK. CAD FILE AVAILABLE FOR SETOUT ON REQUEST. © BAXTER DESIGN

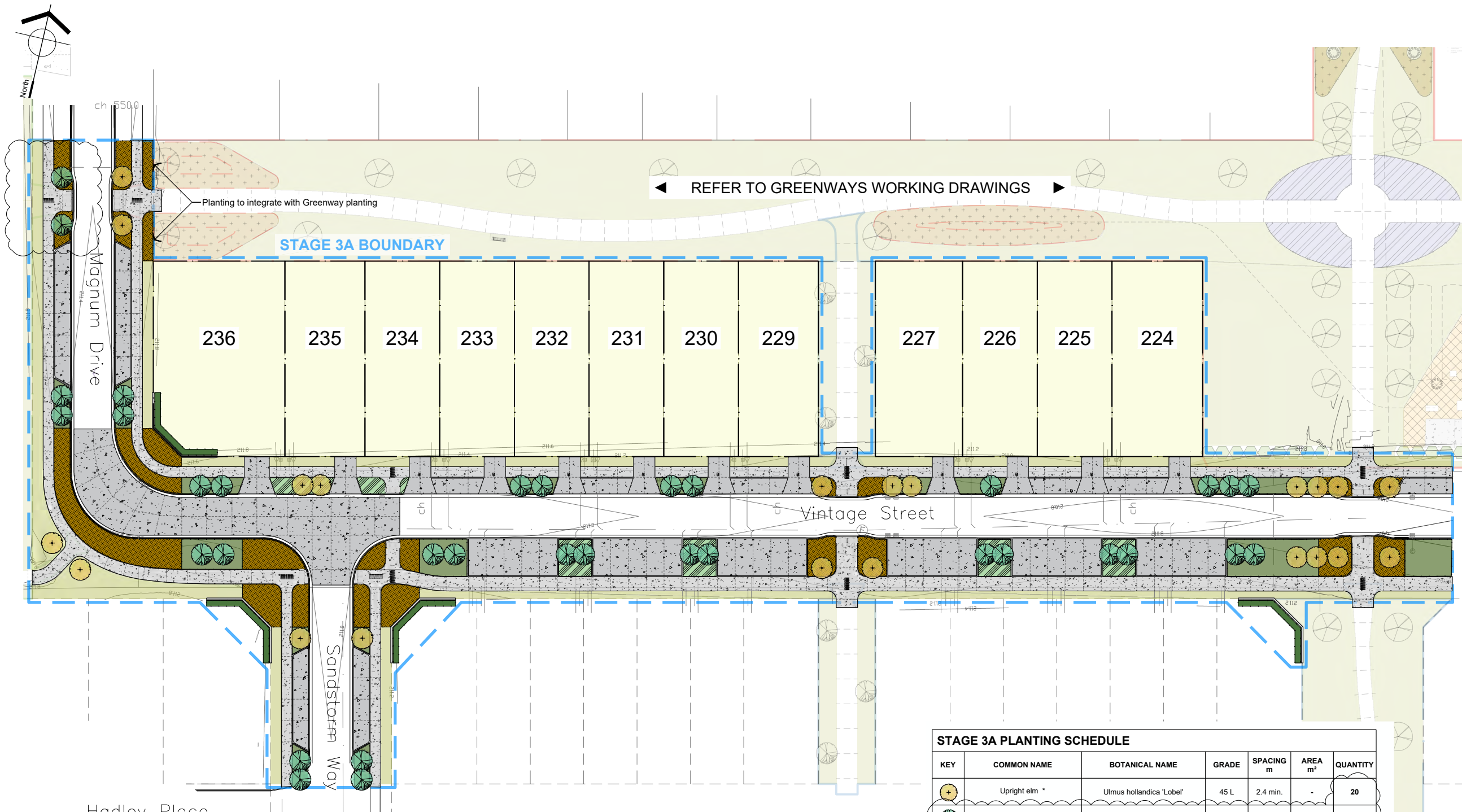

REFER TO GREENWAYS WORKING DRAWINGS

STAGE 3A BOUNDARY

Planting to integrate with Greenway planting

Magnum Drive

Vintage Street

Sandstone Way

Hadley Place

STAGE 3A PLANTING SCHEDULE

KEY	COMMON NAME	BOTANICAL NAME	GRADE	SPACING m	AREA m ²	QUANTITY
	Upright elm *	Ulmus hollandica 'Lobel'	45 L	2.4 min.	-	20
	Upright Hornbeam	Carpinus betulus 'Fastigiata'	45 L	2.4 min.	-	33
	Pittosporum Kohuhu - Hedge	Pittosporum tenuifolium 'Black Matipo'	PB12	0.6	60 lin.m	100
	Creeping wire vine and / or Ground cover Coprosma ** #	Muehlenbeckia axillaris and / or Coprosma acerosa 'Hawera'	PB2	0.6	350	972
	Leatherleaf sedge **	Carex buchananii	PB2	0.5	440	1760
	Hebe **	Hebe topiaria	PB2	1.0	120	120
	"Swale And Amenity Mix" grass to road reserves	Refer to Landscape Specification. Mix to CODC requirements	-	25 kg/ha	660	1.7 kg
	"Premium Area Mix" grass to lots	Refer to Landscape Specification. Mix to CODC requirements	-	25 kg/ha	3850	9.6 kg

* All trees to have 2x 75mmØ tanalised stakes to each tree. Refer Materials Plans
 * All trees to be planted directly to avoid any as built services and away from street lighting [by others]
 * Planting to have minimum 75mm deep arborist chip applied : 2300m²
 ** CODC are not responsible for the maintenance of all 'creeping wire vine' and 'leatherleaf sedge' within the road reserve. Wooring Tree Property Development LP or The Wooring Tree Residents Society will maintain the 'creeping wire vine' and 'leatherleaf sedge' in perpetuity.
 # Selection to be made depending on plant availability. Planting to be mirrored on opposite sides of road.
 - Contractor to verify all quantities before construction.

1 PLANTING PLAN
Scale: 1:300 at A1 / 1:600 at A3

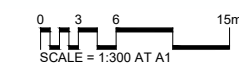

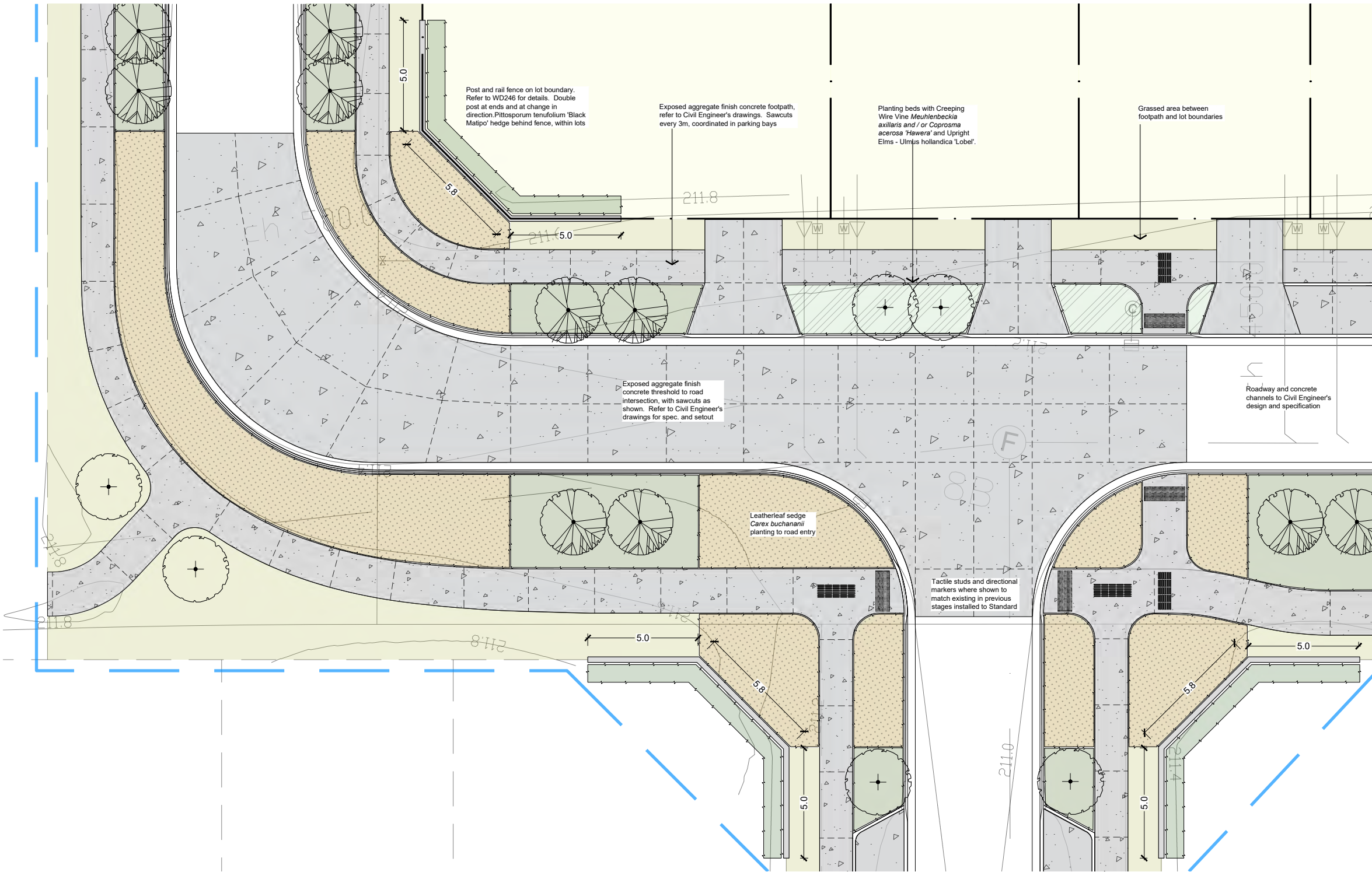
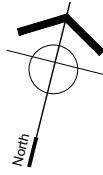

VEROS PROPERTY SERVICES
Woong Tree Estate
2953-WD404
Stage 3A Intersection Detail

CONSULTANTS	
Project Managers	
Architect	
Engineer	
Surveyor	
Paterson Pitts	
Others	

REVISIONS		
Rev.	Date	Description
0	06 Jun 2023	First Issue

Drawing Title:	Stage 3A Intersection Detail
Scale:	As shown
Date:	Oct 2019
Sheet Number:	WD404
Job Number:	2953
Designed:	GH
Drawn:	GH
Checked:	---

DO NOT SCALE DRAWING
CONTRACTOR TO VERIFY ALL DIMENSIONS PRIOR TO COMMENCING ANY WORK. CAD FILE AVAILABLE FOR SETOUT ON REQUEST. © BAXTER DESIGN

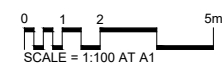



VEROS PROPERTY SERVICES

Wooring Tree
Estate

2953-WD405
Stage 3A Schedules

CONSULTANTS
Project Managers

Architect

Engineer

Surveyor

Paterson Pitts

Others

REVISIONS

Rev.	Date	Description
0	06 Jun 2023	First Issue
A	22 Aug 2023	Trees revised to suit street lighting

Drawing Title: Stage 3A Schedules

Scale: As shown

Date: Oct 2019

Sheet Number: WD405





Job Number: 2953

Designed: GH



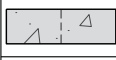

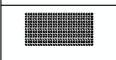

Drawn: GH

Checked: ---

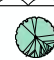
DO NOT SCALE DRAWING
CONTRACTOR TO VERIFY ALL DIMENSIONS PRIOR TO
COMMENCING ANY WORK. CAD FILE AVAILABLE FOR
SETOUT ON REQUEST. © BAXTER DESIGN

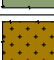
STAGE 3A MATERIALS SCHEDULE		
KEY	MATERIAL	QUANTITY
	Exposed aggregate finish concrete - road spec.*	1200 m ²
	Exposed aggregate finish concrete - footpath spec.*	975 m ²
	Post and rail fencing. Refer : WD246	64 Lm 4No.
	Tactile studs at footpath crossings. Reference: GMSSS10 from Freedom Strategies	6200
	Tactile directional indicators. Reference: GMSSD10 from Freedom Strategies	382
	2x 75mmØ tanalised H4 stakes to each tree, refer WD245 All pairs of posts to be consistently aligned	106

- * All exposed aggregate finish concrete to have sawcuts as shown at fixed spacings
- * Footpaths to have sawcuts at 3m [maximum] even spacings, coordinated at parking bays
- * Sawcuts shown dashed for clarity
- * Contractor to verify all quantities before construction
- * CAD file available for setout on request

STAGE 3A PLANTING SCHEDULE						
KEY	COMMON NAME	BOTANICAL NAME	GRADE	SPACING m	AREA m ²	QUANTITY
	Upright elm *	Ulmus hollandica 'Lobel'	45 L	2.4 min.	-	20
	Upright Hornbeam	Carpinus betulus 'Fastigiata'	45 L	2.4 min.	-	33
	Pittosporum Kohuhu - Hedge	Pittosporum tenuifolium 'Black Matipo'	PB12	0.6	60 lin.m	100
	Creeping wire vine and / or Ground cover Coprosma ** #	Muehlenbeckia axillaris and / or Coprosma acerosa 'Hawera'	PB2	0.6	350	972
	Leatherleaf sedge **	Carex buchananii	PB2	0.5	440	1760
	Hebe **	Hebe topiaria	PB2	1.0	120	120
	"Swale And Amenity Mix" grass to road reserves	Refer to Landscape Specification. Mix to CODC requirements	-	25 kg/ha	660	1.7 kg
	"Premium Area Mix" grass to lots	Refer to Landscape Specification. Mix to CODC requirements	-	25 kg/ha	3850	9.6 kg

- * All trees to have 2x 75mmØ tanalised stakes to each tree. Refer Materials Plans
- * All trees to be planted directly to avoid any as built services and away from street lighting [by others]
- ** Planting to have minimum 75mm deep arborist chip applied : 2300m²
- ** CODC are not responsible for the maintenance of all 'creeping wire vine' and 'leatherleaf sedge' within the road reserve. *Wooring Tree Property Development LP or The Wooring Tree Residents Society* will maintain the 'creeping wire vine' and 'leatherleaf sedge' in perpetuity.
- # Selection to be made depending on plant availability. Planting to be mirrored on opposite sides of road.
- Contractor to verify all quantities before construction.

0 1.5 3 7.5m
SCALE = 1:150 AT A1

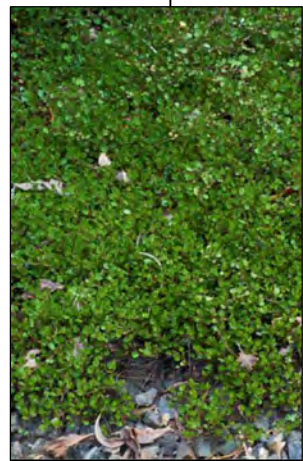
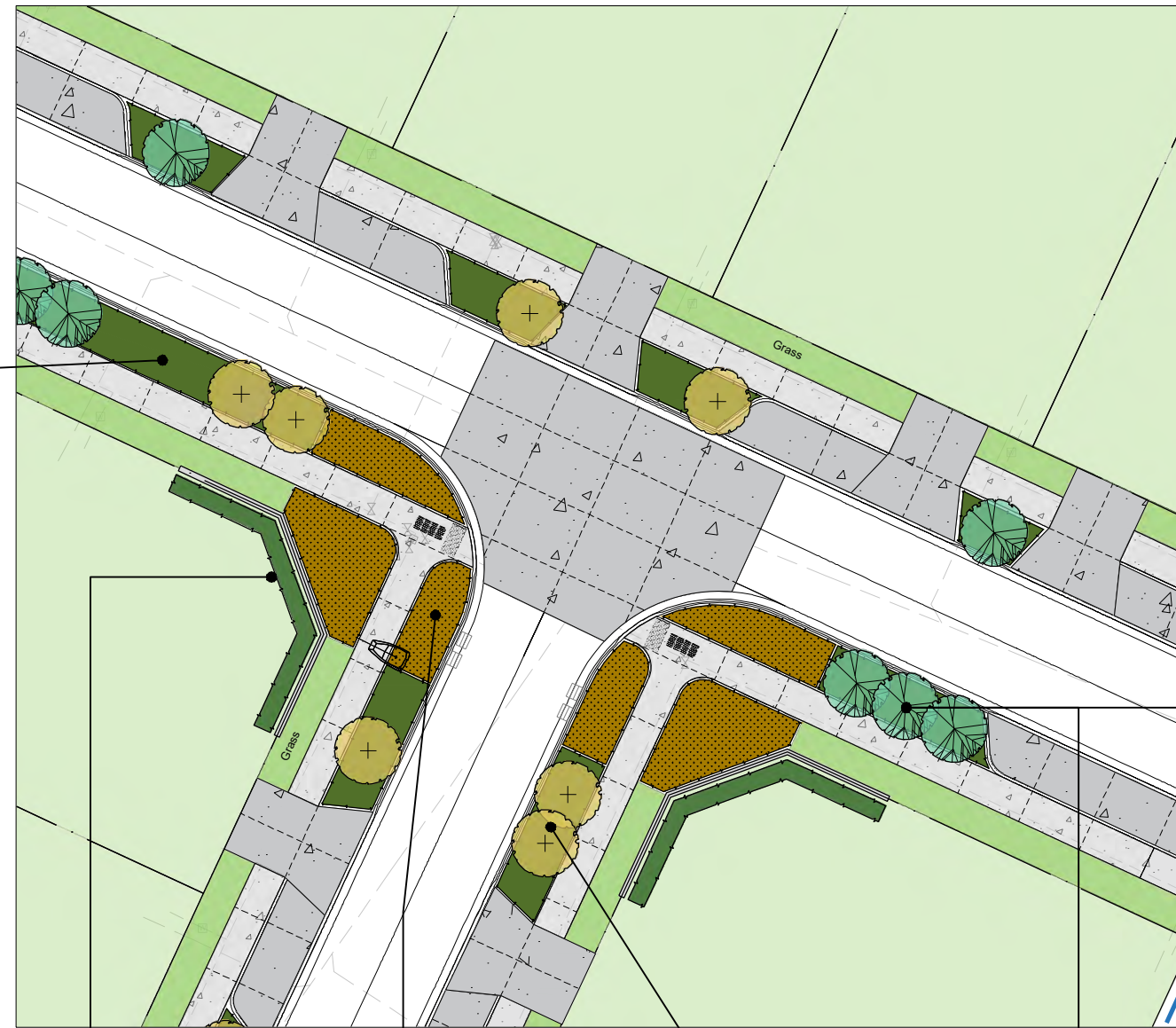

Creeping wire vine - ground cover



Pittosporum Kohuhu - Hedge



Leatherleaf Sedge at intersections



Upright elms - street trees



Upright Hornbeams - street trees

or



English Beech - street trees [TBC]



50 Stanley Street
2nd Floor
Queenstown 9300
P.O. Box 740
Queenstown 9348
New Zealand
+64 3 442 8119
www.baxterdesign.nz



VEROS PROPERTY SERVICES

Woong Tree Estate

2953-WD228

Planting Schematic

CONSULTANTS	
Project Managers	
Architect	
Engineer	
Surveyor	
Paterson Pitts	
Others	

REVISIONS		
Rev.	Date	Description
0	24 Jul 2020	First Issue
A	09 Dec 2020	Plan revised to new lot and driveways layout

Drawing Title: Planting Schematic
Scale: As shown
Date: Oct 2019
Sheet Number: WD228
Job Number: 2953
Designed: GH
Drawn: GH
Checked: ---

DO NOT SCALE DRAWING
CONTRACTOR TO VERIFY ALL DIMENSIONS PRIOR TO
COMMENCING ANY WORK. CAD FILE AVAILABLE FOR
SETOUT ON REQUEST. © BAXTER DESIGN



Registered
NZILA
Landscape
Architect

50 Stanley Street
2nd Floor
Queenstown 9300
P.O. Box 740
Queenstown 9348
New Zealand
+64 3 442 8119
www.baxterdesign.nz



VEROS PROPERTY SERVICES

Woong Tree Estate

2953-WD241

Typical Planting Bed Plan

CONSULTANTS

Project Managers

Architect

Engineer

Surveyor

Paterson Pitts

Others

REVISIONS

Rev.	Date	Description
0	02 Sep 2021	First Issue
A	17 Nov 2021	Revised to PPG changes + Veros comments

Drawing Title: Typical Planting Bed Plan

Scale: As shown

Date: Oct 2019

Sheet Number: WD241

Job Number: 2953

Designed: GH

Drawn: GH

Checked: ---

DO NOT SCALE DRAWING
CONTRACTOR TO VERIFY ALL DIMENSIONS PRIOR TO
COMMENCING ANY WORK. CAD FILE AVAILABLE FOR
SETOUT ON REQUEST. © BAXTER DESIGN

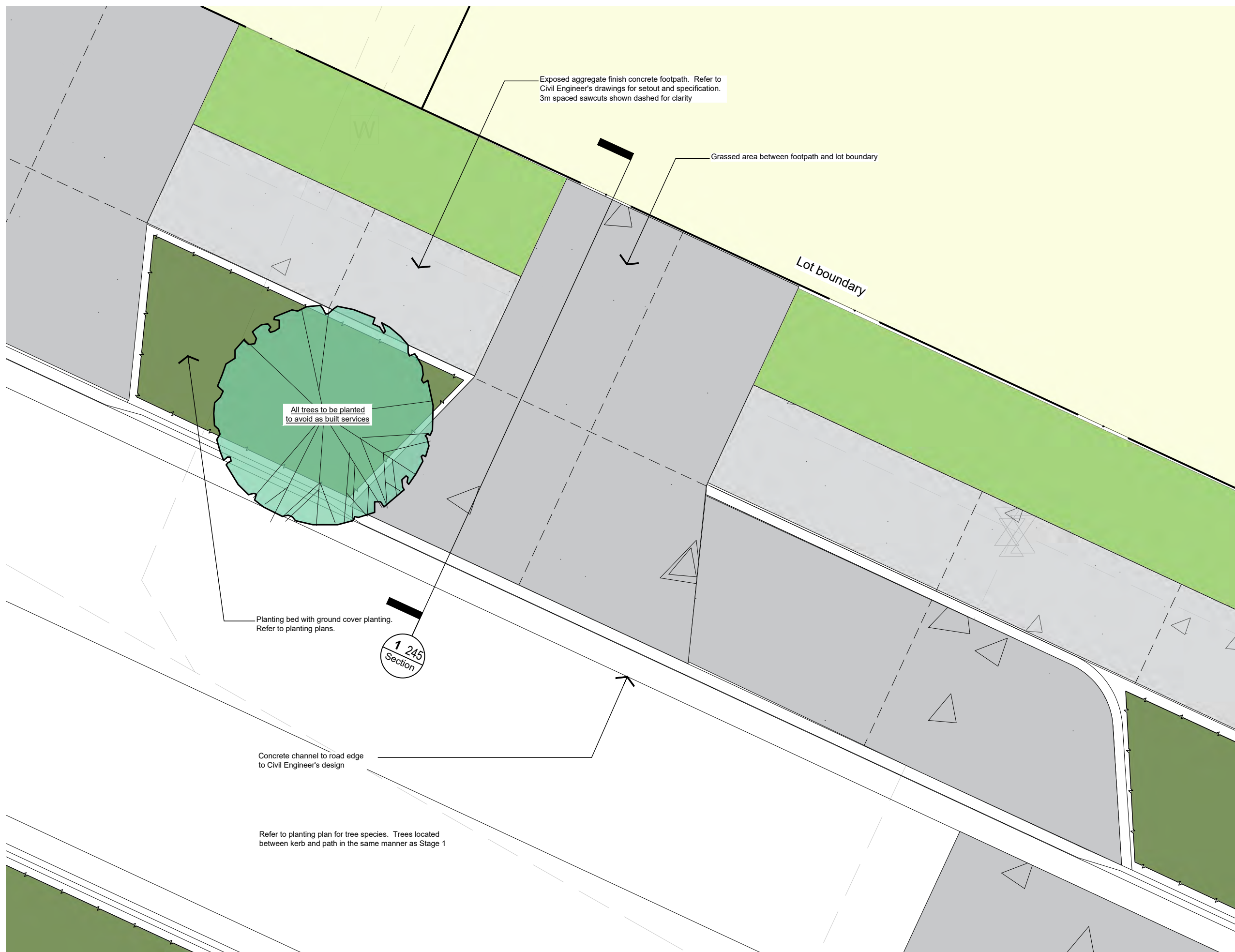

1 TYPICAL PLANTING BED PLAN

Scale: 1:25 at A1 / 1:50 at A3

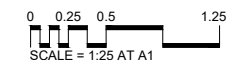



Registered
NZILA
Landscape
Architect

50 Stanley Street
2nd Floor
Queenstown 9300
P.O. Box 740
Queenstown 9348
New Zealand
+64 3 442 8119
www.baxterdesign.nz



VEROS PROPERTY SERVICES

Woong Tree
Estate

2953-WD242

Typical Road Corridor

CONSULTANTS
Project Managers

Architect

Engineer

Surveyor

Paterson Pitts

Others

REVISIONS

Rev.	Date	Description
0	02 Sep 2021	First Issue
A	17 Nov 2021	Revised to PPG changes + Veros comments

Drawing Title: Typical Road Corridor

Scale: As shown

Date: Oct 2019

Sheet Number: WD242

Job Number: 2953

Designed: GH

Drawn: GH

Checked: ---

DO NOT SCALE DRAWING
CONTRACTOR TO VERIFY ALL DIMENSIONS PRIOR TO
COMMENCING ANY WORK. CAD FILE AVAILABLE FOR
SETOUT ON REQUEST. © BAXTER DESIGN

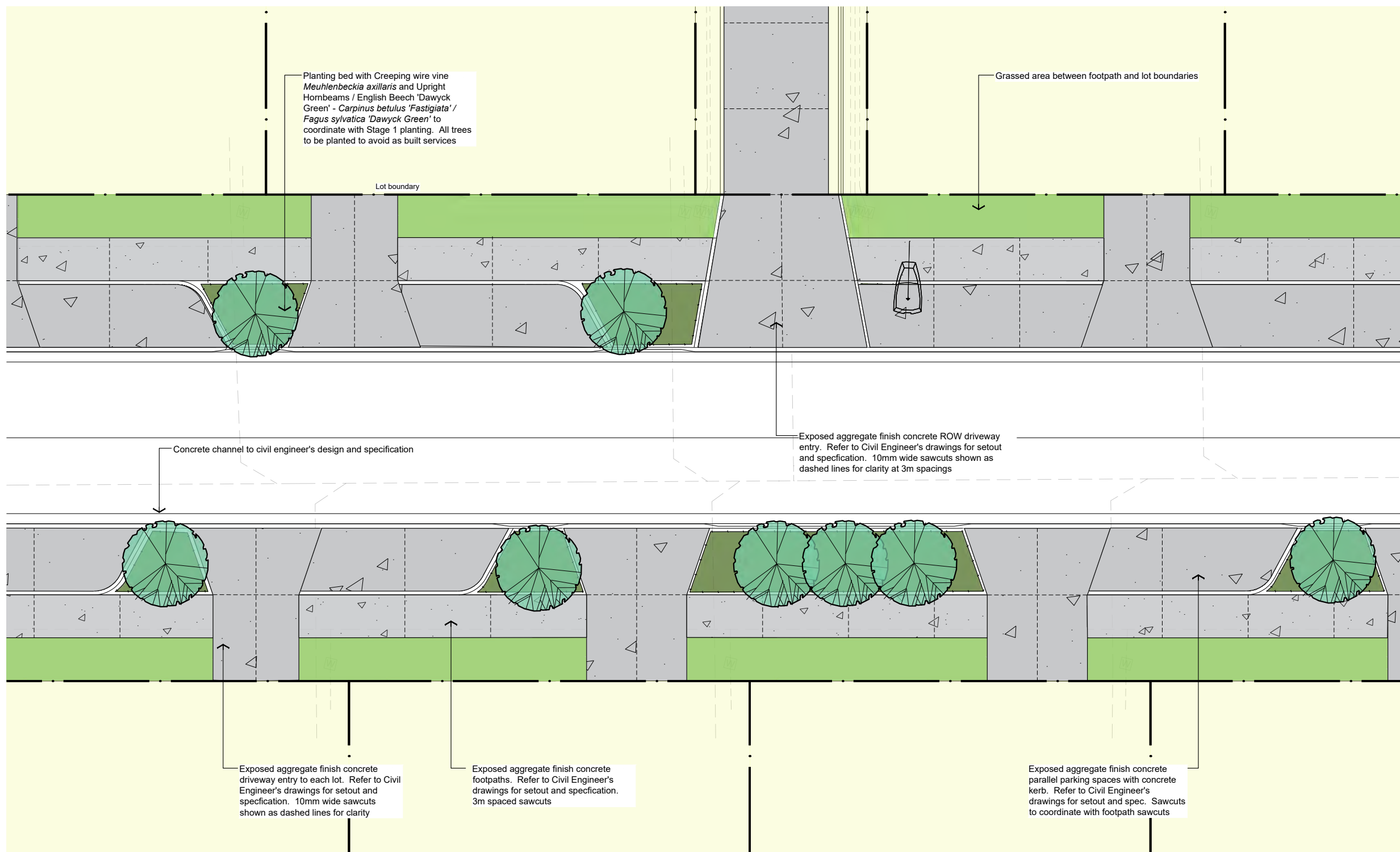

1 TYPICAL ROAD CORRIDOR
Scale: 1:75 at A1 / 1:150 at A3



50 Stanley Street
2nd Floor
Queenstown 9300
P.O. Box 740
Queenstown 9348
New Zealand
+64 3 442 8119
www.baxterdesign.nz



VEROS PROPERTY SERVICES

Woong Tree Estate
2953-WD243
Typical Lot Entries

CONSULTANTS	
Project Managers	
Architect	
Engineer	
Surveyor	
Paterson Pitts	
Others	

REVISIONS		
Rev.	Date	Description
0	02 Sep 2021	First Issue
A	17 Nov 2021	Revised to PPG changes + Veros comments

Drawing Title:	Typical Lot Entries
Scale:	As shown
Date:	Oct 2019
Sheet Number:	WD243
Job Number:	2953
Designed:	GH
Drawn:	GH
Checked:	---

DO NOT SCALE DRAWING
CONTRACTOR TO VERIFY ALL DIMENSIONS PRIOR TO COMMENCING ANY WORK. CAD FILE AVAILABLE FOR SETOUT ON REQUEST. © BAXTER DESIGN

1 TYPICAL LOT ENTRIES
Scale: 1:25 at A1 / 1:50 at A3

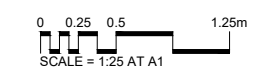



Registered
NZILA
Landscape
Architect

50 Stanley Street
2nd Floor
Queenstown 9300
P.O. Box 740
Queenstown 9348
New Zealand
+64 3 442 8119
www.baxterdesign.nz



VEROS PROPERTY SERVICES

Woong Tree Estate

2953-WD244

Typical Parallel Park

CONSULTANTS

Project Managers

Architect

Engineer

Surveyor

Paterson Pitts

Others

REVISIONS

Rev.	Date	Description
0	02 Sep 2021	First Issue
A	17 Nov 2021	Revised to PPG changes + Veros comments

Drawing Title: Typical Parallel Park

Scale: As shown

Date: Oct 2019

Sheet Number: WD244

Job Number: 2953

Designed: GH

Drawn: GH

Checked: ---

DO NOT SCALE DRAWING
CONTRACTOR TO VERIFY ALL DIMENSIONS PRIOR TO
COMMENCING ANY WORK. CAD FILE AVAILABLE FOR
SETOUT ON REQUEST. © BAXTER DESIGN

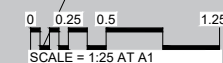
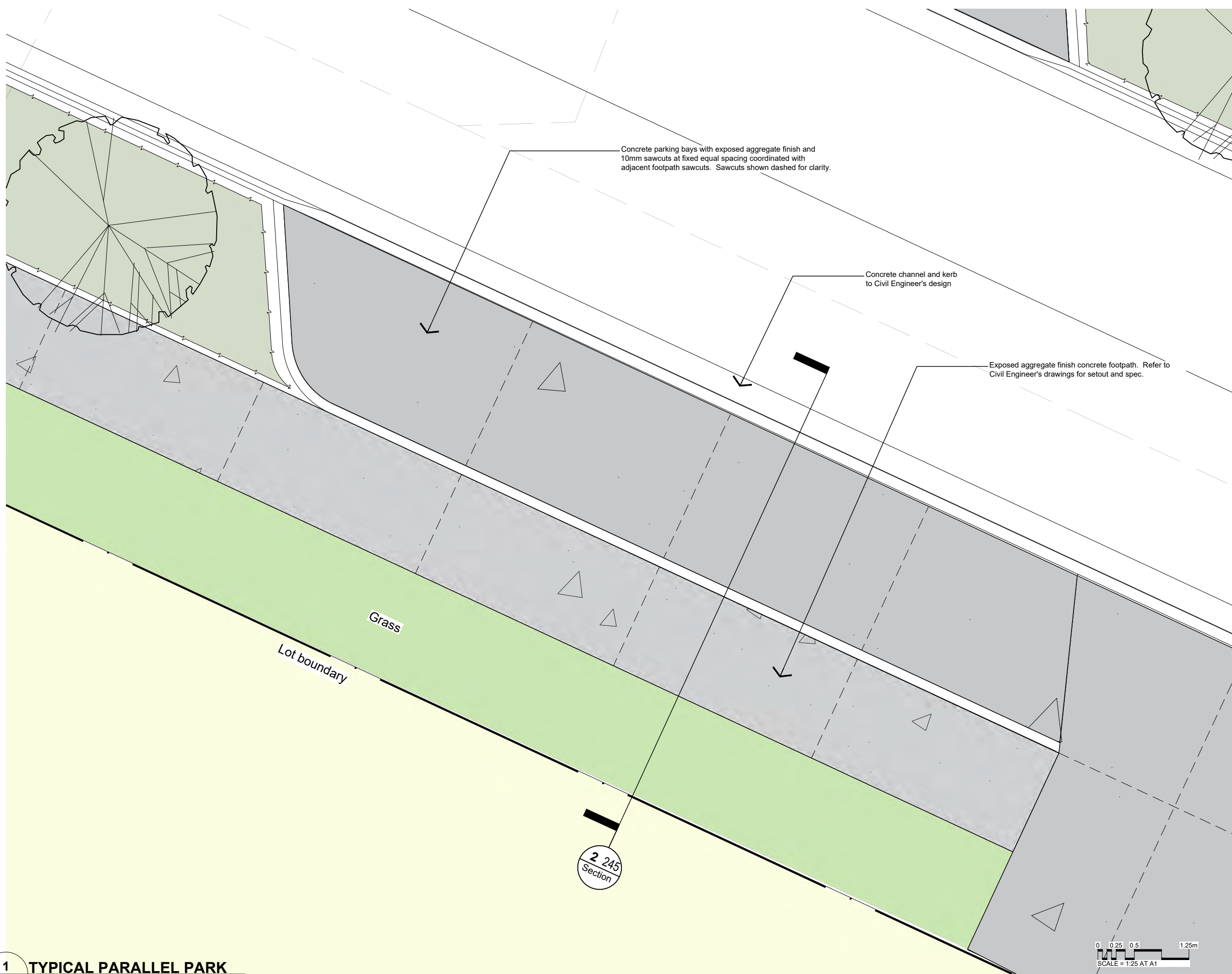

1 TYPICAL PARALLEL PARK

Scale: 1:25 at A1 / 1:50 at A3

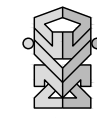

Registered
NZILA
Landscape
Architect

50 Stanley Street
2nd Floor
Queenstown 9300
P.O. Box 740
Queenstown 9348
New Zealand
+64 3 442 8119
www.baxterdesign.nz



VEROS PROPERTY SERVICES

Woong Tree Estate
2953-WD245
Typical Sections

CONSULTANTS
Project Managers
Architect
Engineer
Surveyor
Paterson Pitts
Others

REVISIONS

Rev.	Date	Description
0	02 Sep 2021	First Issue

Drawing Title: Typical Sections
Scale: As shown
Date: Oct 2019
Sheet Number: WD245
Job Number: 2953
Designed: GH
Drawn: GH
Checked: ---

DO NOT SCALE DRAWING
CONTRACTOR TO VERIFY ALL DIMENSIONS PRIOR TO
COMMENCING ANY WORK. CAD FILE AVAILABLE FOR
SETOUT ON REQUEST. © BAXTER DESIGN

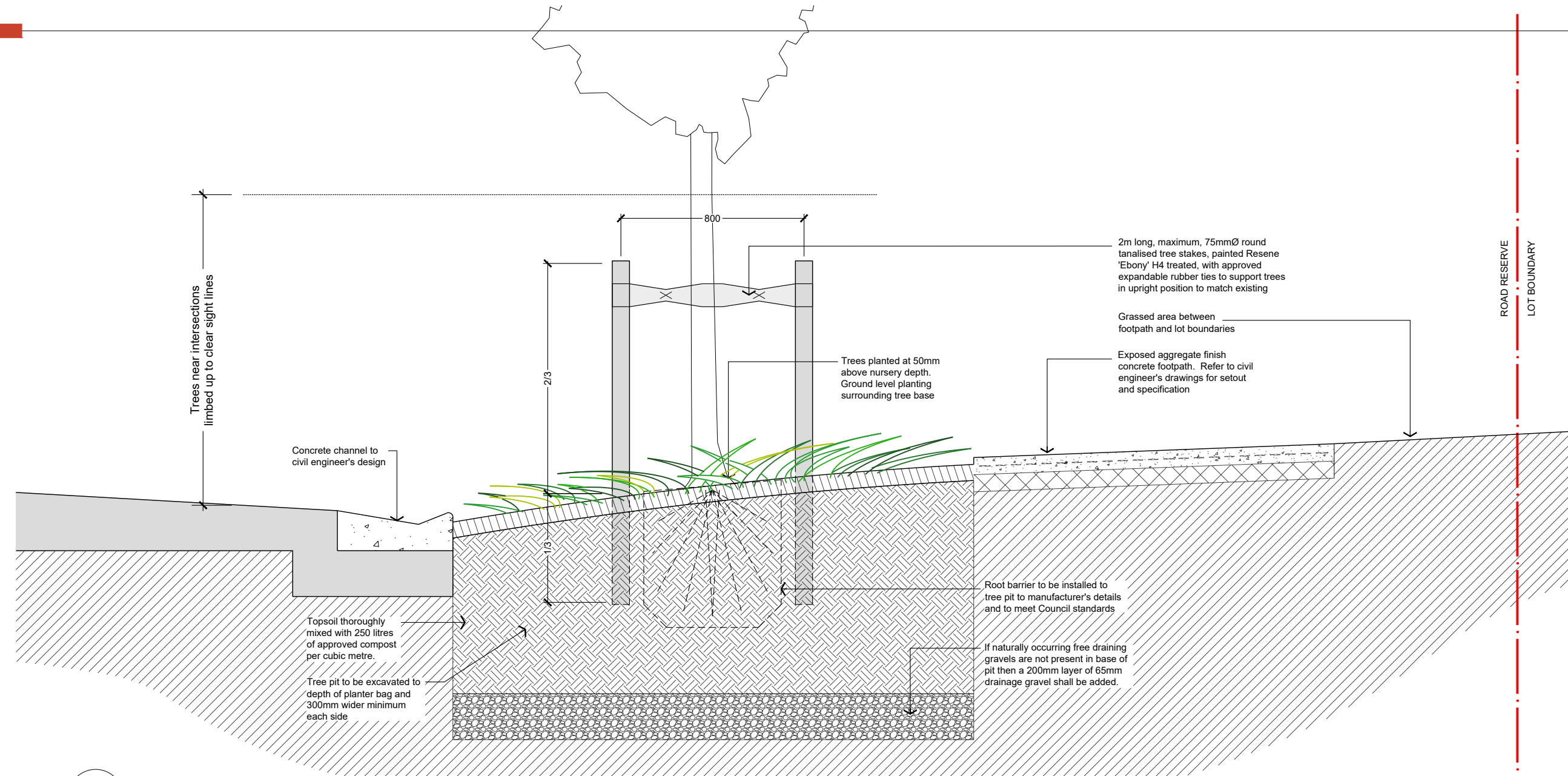

1 TYPICAL TREE PLANTING AND FOOTPATH SECTION

Scale: 1:10 at A1 / 1:20 at A3

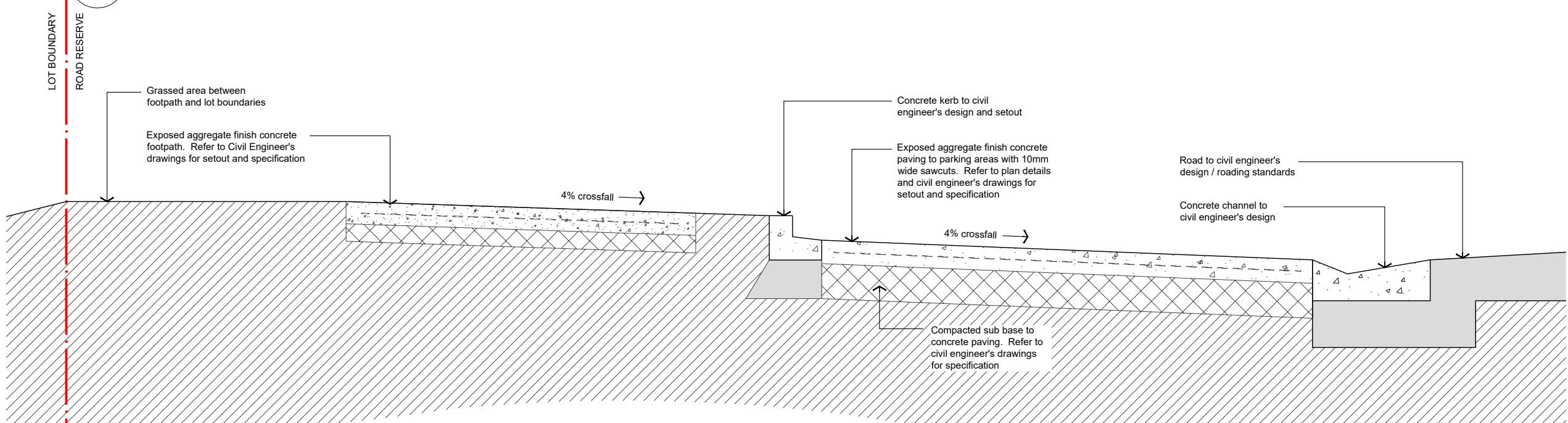

2 TYPICAL FOOTPATH AND PARKING SECTION

Scale: 1:10 at A1 / 1:20 at A3

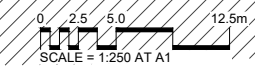



Registered
NZ I L A
Landscape
Architect

50 Stanley Street
2nd Floor
Queenstown 9300
P.O. Box 740
Queenstown 9348
New Zealand
+64 3 442 8119
www.baxterdesign.nz



VEROS PROPERTY SERVICES

Woong Tree Estate

2953-WD246
Post And Rail Details

CONSULTANTS
Project Managers

Architect

Engineer

Surveyor

Paterson Pitts

Others

REVISIONS

Rev.	Date	Description
0	02 Sep 2021	First Issue
A	22 May 2022	Fencing Along SH Boundary detail added

Drawing Title: Post And Rail Details

Scale: As shown

Date: Oct 2019

Sheet Number: WD246

Job Number: 2953

Designed: GH

Drawn: GH

Checked: ---

DO NOT SCALE DRAWING
CONTRACTOR TO VERIFY ALL DIMENSIONS PRIOR TO
COMMENCING ANY WORK. CAD FILE AVAILABLE FOR
SETOUT ON REQUEST. © BAXTER DESIGN

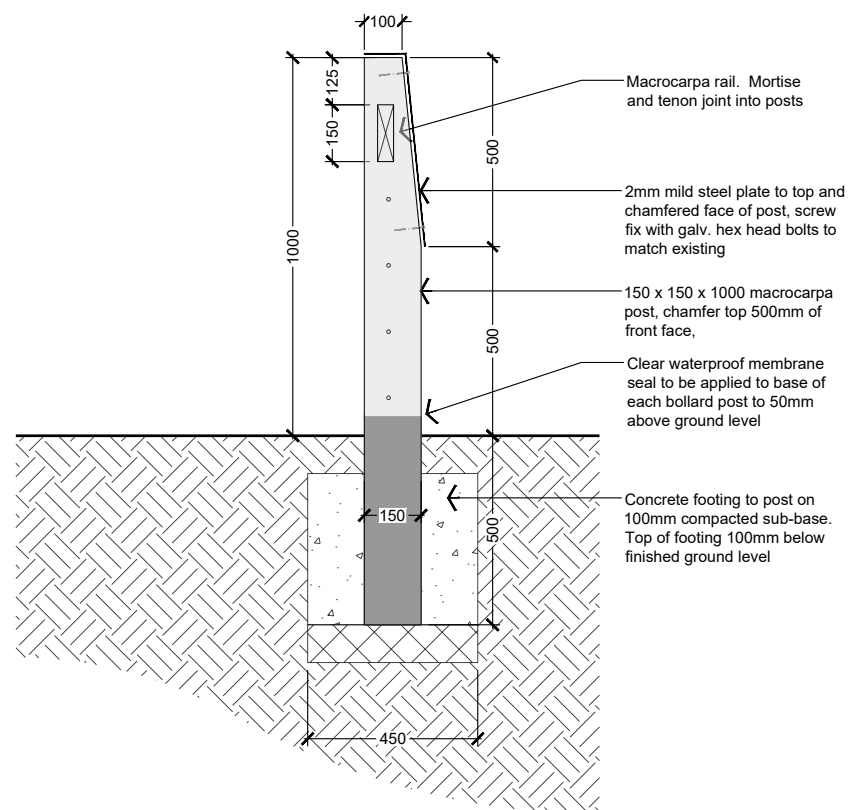
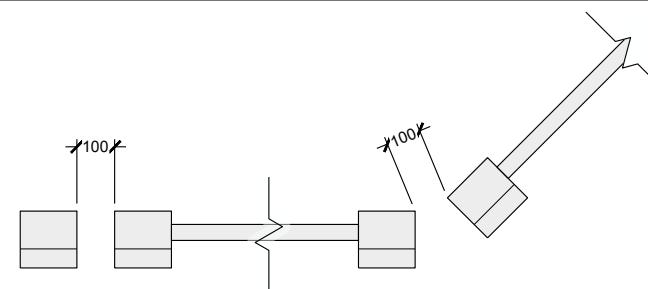

1 POST AND RAIL FENCE DETAILS

Scale: 1:10 at A1 / 1:20 at A3



EXAMPLE BOUNDARY FENCING IMAGE

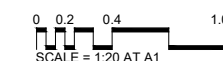
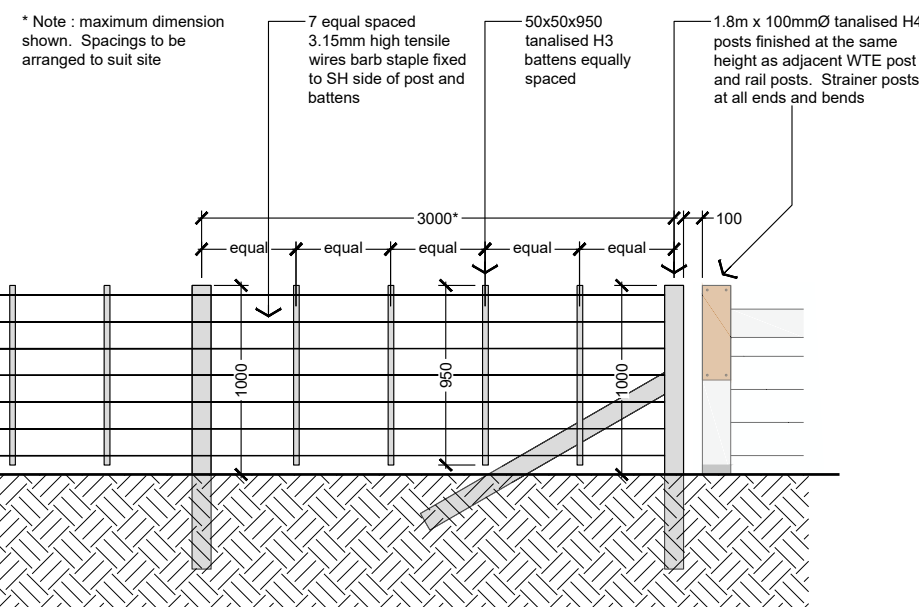
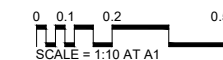
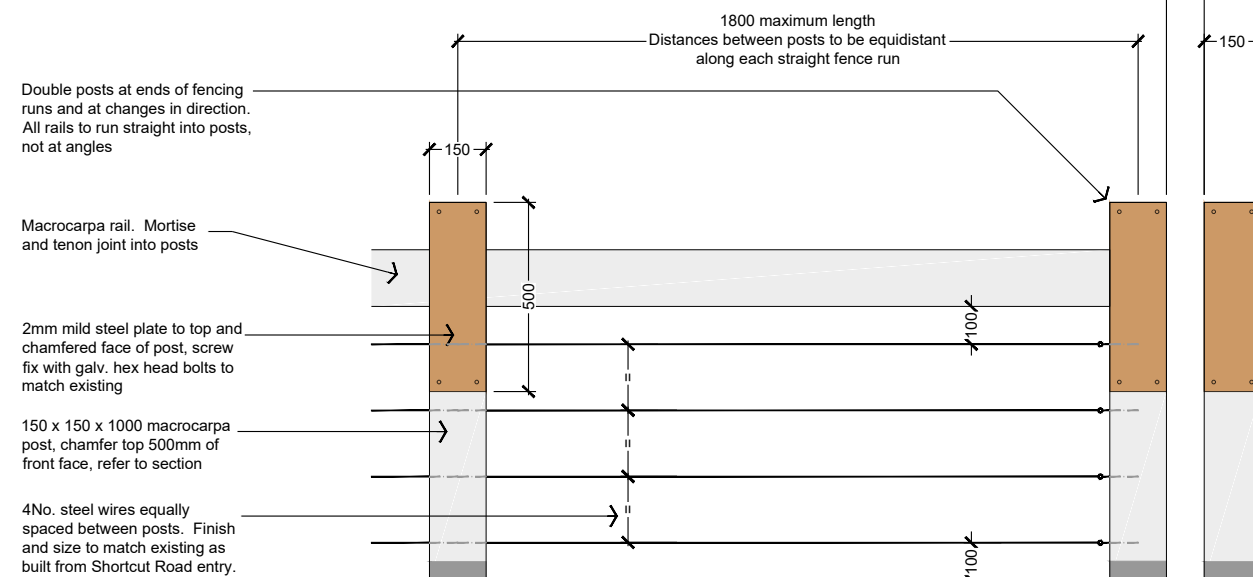

2 'FARM' FENCING ALONG SH BOUNDARY

Scale: 1:20 at A1 / 1:40 at A3